

GDCC-250

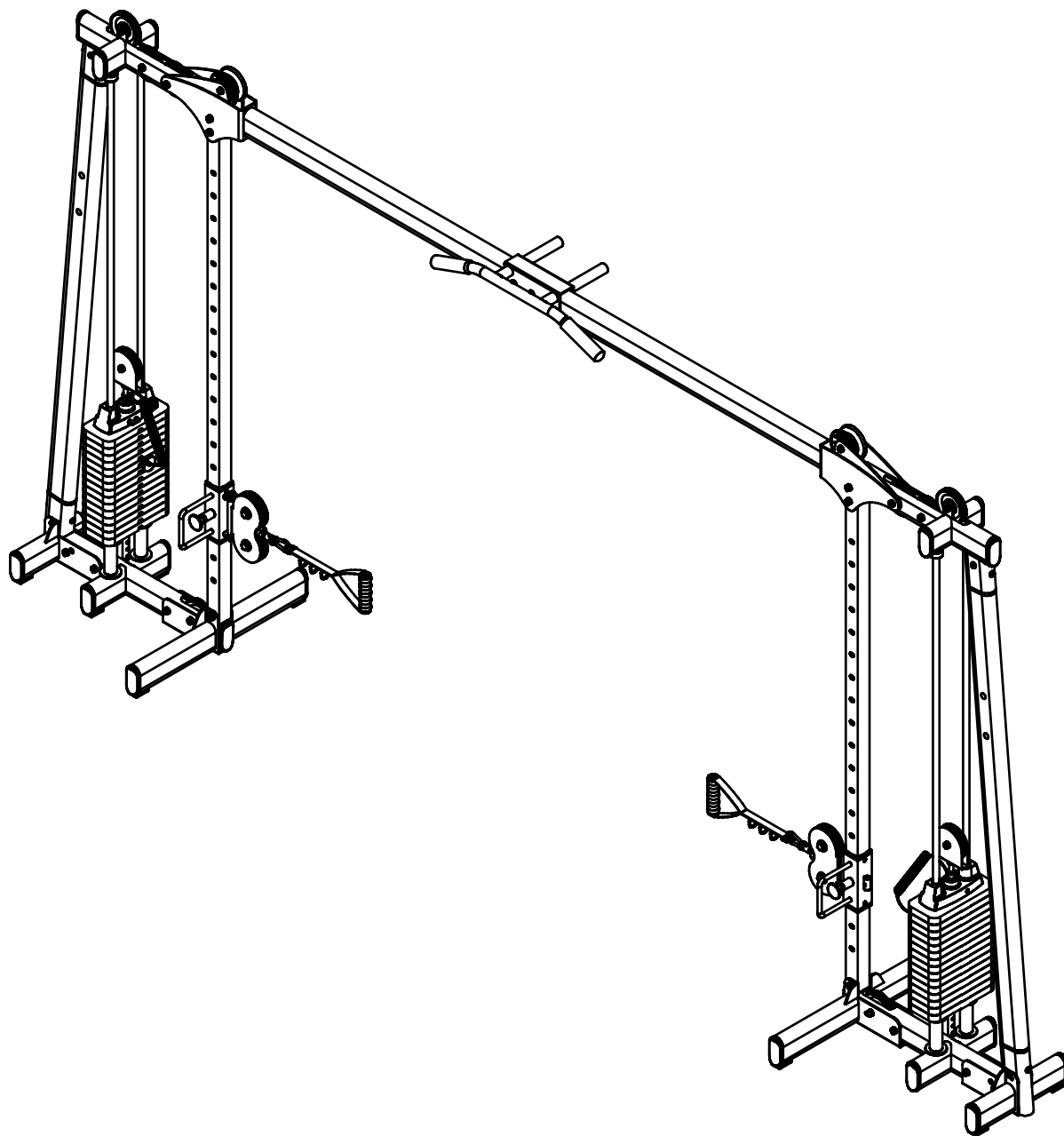

VERSION 0608

GDCC-250

HARDWARE ILLUSTRATION SHEET Qty.

- A3. M10X75 HEX HEAD BOLT-----[3PCS]
- A8. M10X85 HEX HEAD BOLT-----[6PCS]
- B2. M10 NYLON LOCK NUT-----[3PCS]
- C3. M10(I.D) WASHER-----[6PCS]
- D16. ROUND END CAP (9211-061)-----[8PCS]

A3

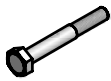

A8



B2



C3



D16



PARTS ILLUSTRATION SHEET

I[1PCS]

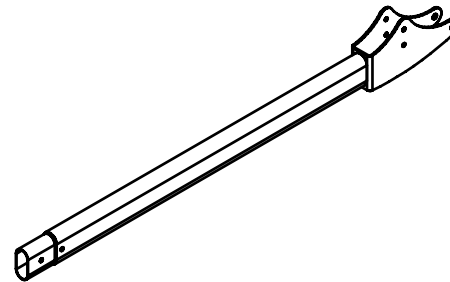

K[1PCS]

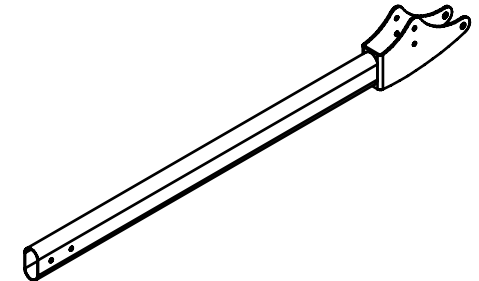

L[1PCS]

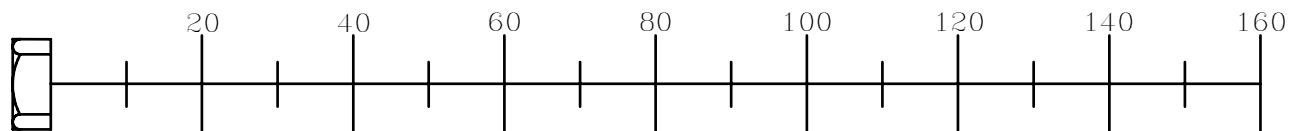
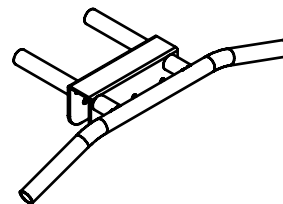

	Qty.
A1. 1/2"X50 HEX HEAD BOLT-----	[4PCS]
A2. 3/8"X3" HEX HEAD BOLT-----	[2PCS]
A3. M10X75 HEX HEAD BOLT-----	[10PCS]
A4. M10X65 HEX HEAD BOLT-----	[2PCS]
A5. M10X45 HEX HEAD BOLT-----	[4PCS]
A6. M10X80 HEX HEAD BOLT-----	[6PCS]
A7. BALL PIN (8250-071)-----	[2PCS]
B1. 3/8" NYLON LOCK NUT-----	[2PCS]
B2. M10 NYLON LOCK NUT-----	[22PCS]
B3. 1/2" NYLON LOCK NUT-----	[4PCS]
C1. 1/2"(I.D) WASHER-----	[8PCS]
C2. 3/8"(I.D) WASHER-----	[4PCS]
C3. M10(I.D) WASHER-----	[32PCS]
D1. Φ110 PULLEY (9213-002)-----	[10PCS]
D2. Φ4 1/2" PULLEY (9213-010)-----	[4PCS]
D3.Φ109 PULLEY (9213-022)-----	[2PCS]
D4. Φ16XΦ10X16.5L STEEL BUSHING (8530-009)-----	[4PCS]
D5. Φ20XΦ10X21.5L STEEL BUSHING (8530-010)-----	[6PCS]
D6. Φ8 SPRING SNAP LIN (8810-001)-----	[2PCS]
D7. 60X50 NYLON BUSHING (9211-033)-----	[4PCS]
D8.Φ3/4" SHAFT COLLAR (9211-046)-----	[4PCS]
D9. END CAP (9211-114) -----	[8PCS]
D10. FOOT CAP (9211-117) -----	[12PCS]
D11.Φ55 RUBBER DOUNT (9310-027) -----	[4PCS]
D12. 7510mm STEEL CABLE -----	[2PCS]
D13.Φ16XΦ10.2X24L STEEL BUSHING (8530-019)-----	[4PCS]
D14.WEIGHT STACK PIN LANYARD -----	[2PCS]
D15.HANDLE(9630-125) -----	[2PCS]

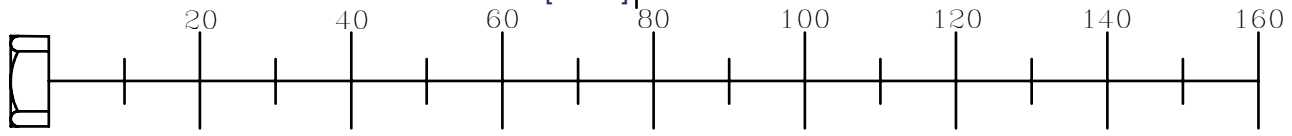
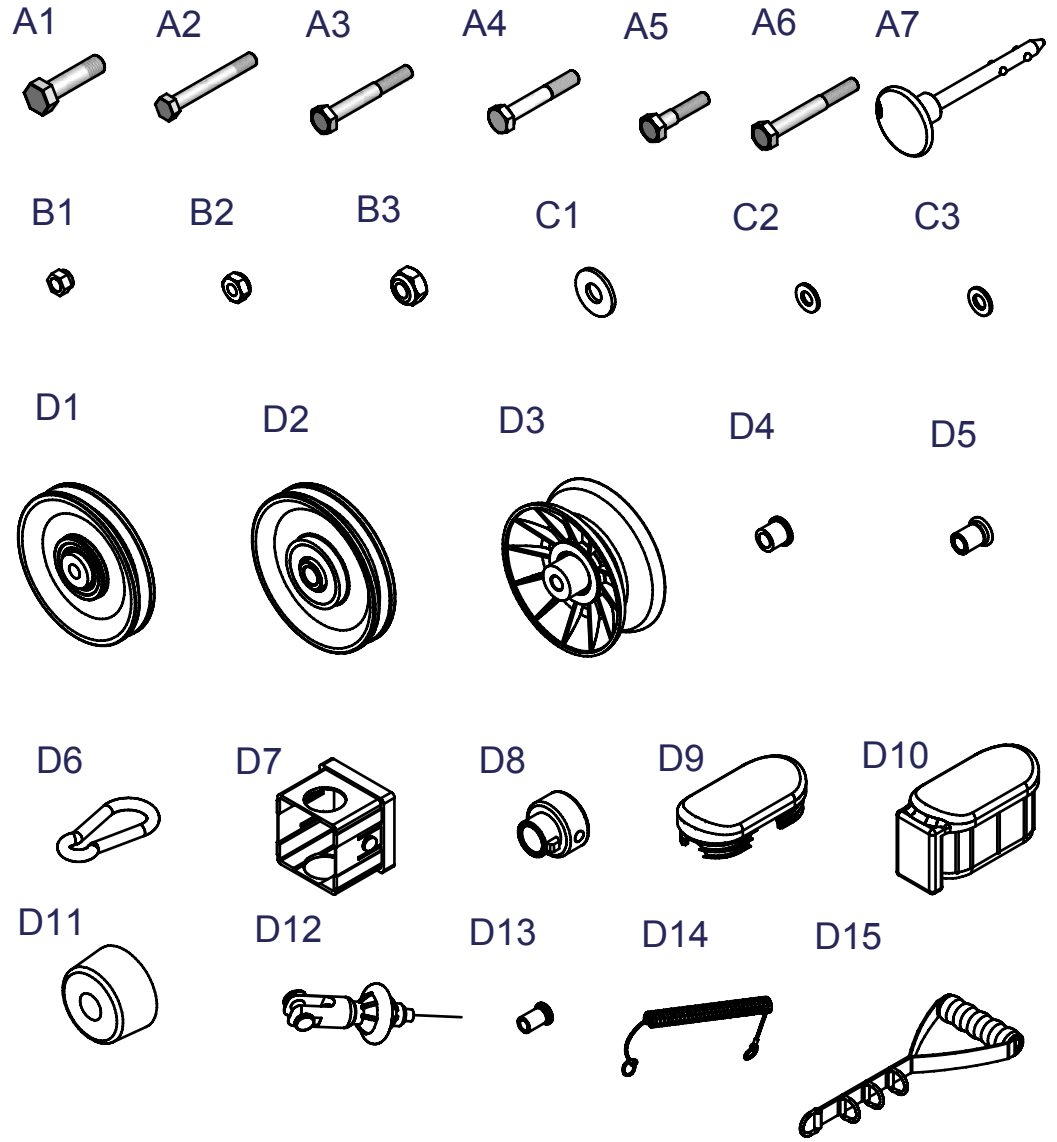

A[2PCS]

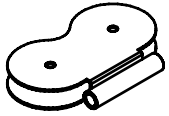

B[2PCS]

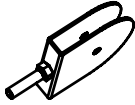

C[2PCS]

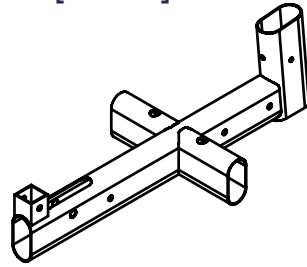

D[2PCS]

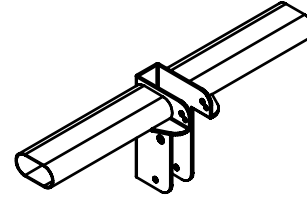

E[2PCS]

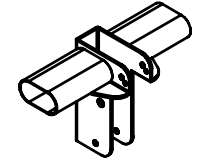

G[2PCS]

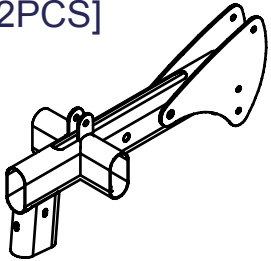

H[4PCS]

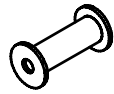

J[2PCS]

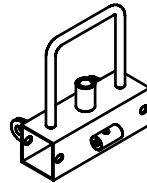

Q[2PCS]

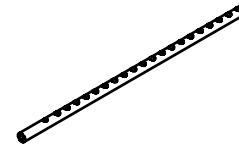

M[2PCS]

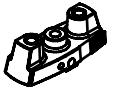

N[2PCS]

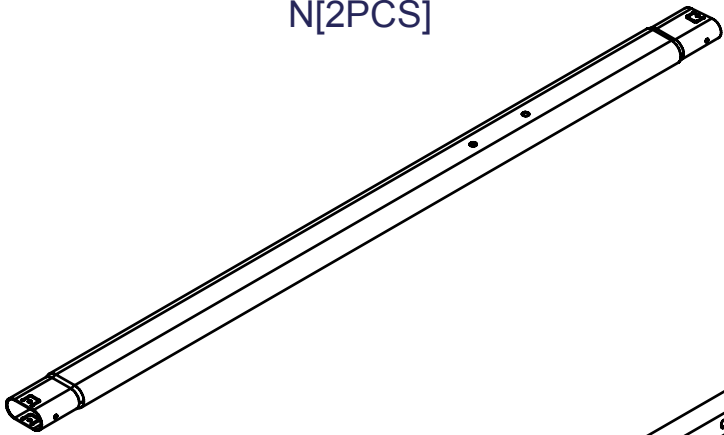

O[2PCS]

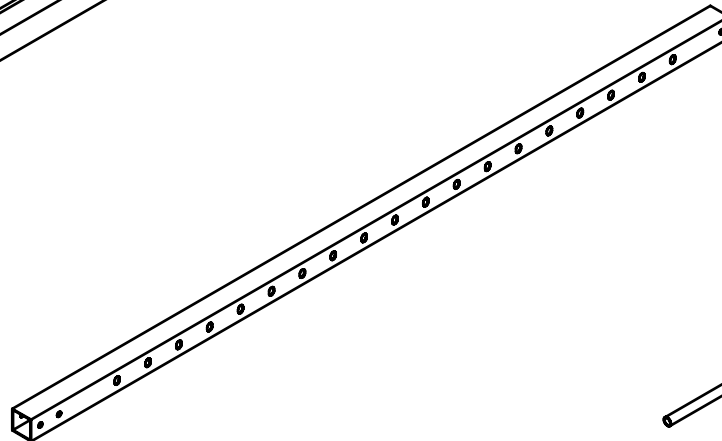

P[4PCS]

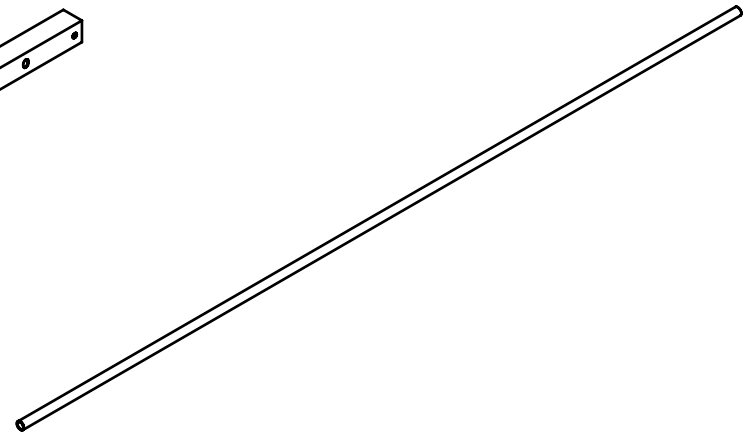

GDCC

For GDCC-250

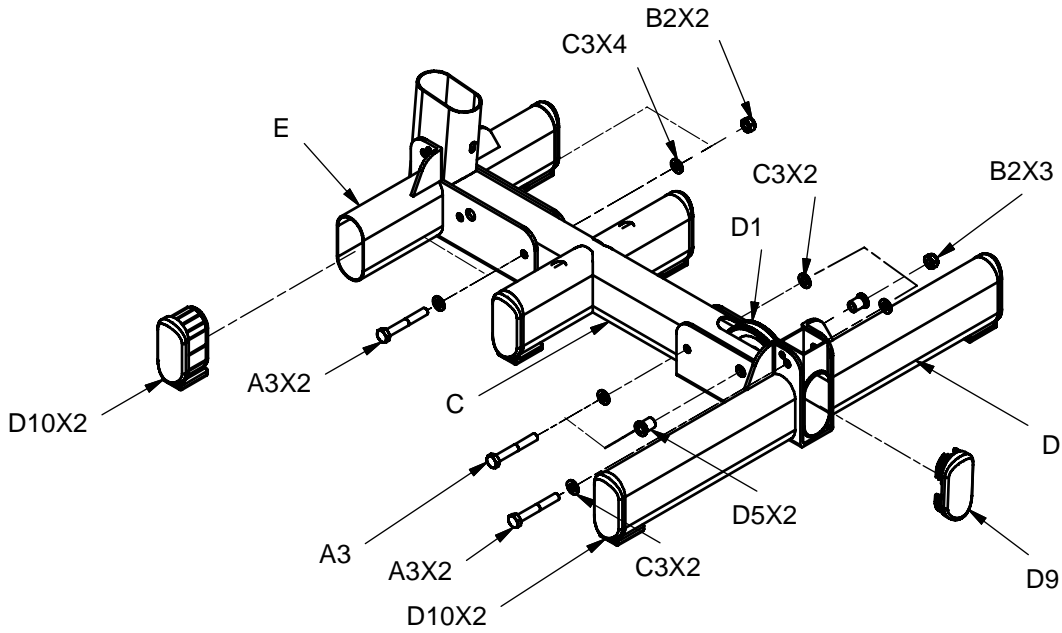

For GDCC-200

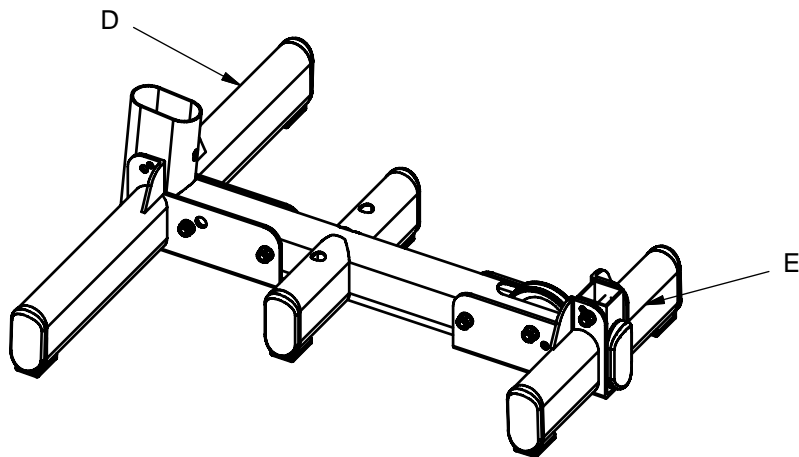

Pay attention to:
change fabricating
positions of D
and E in GDCC
For GDCC200
and GDCC250

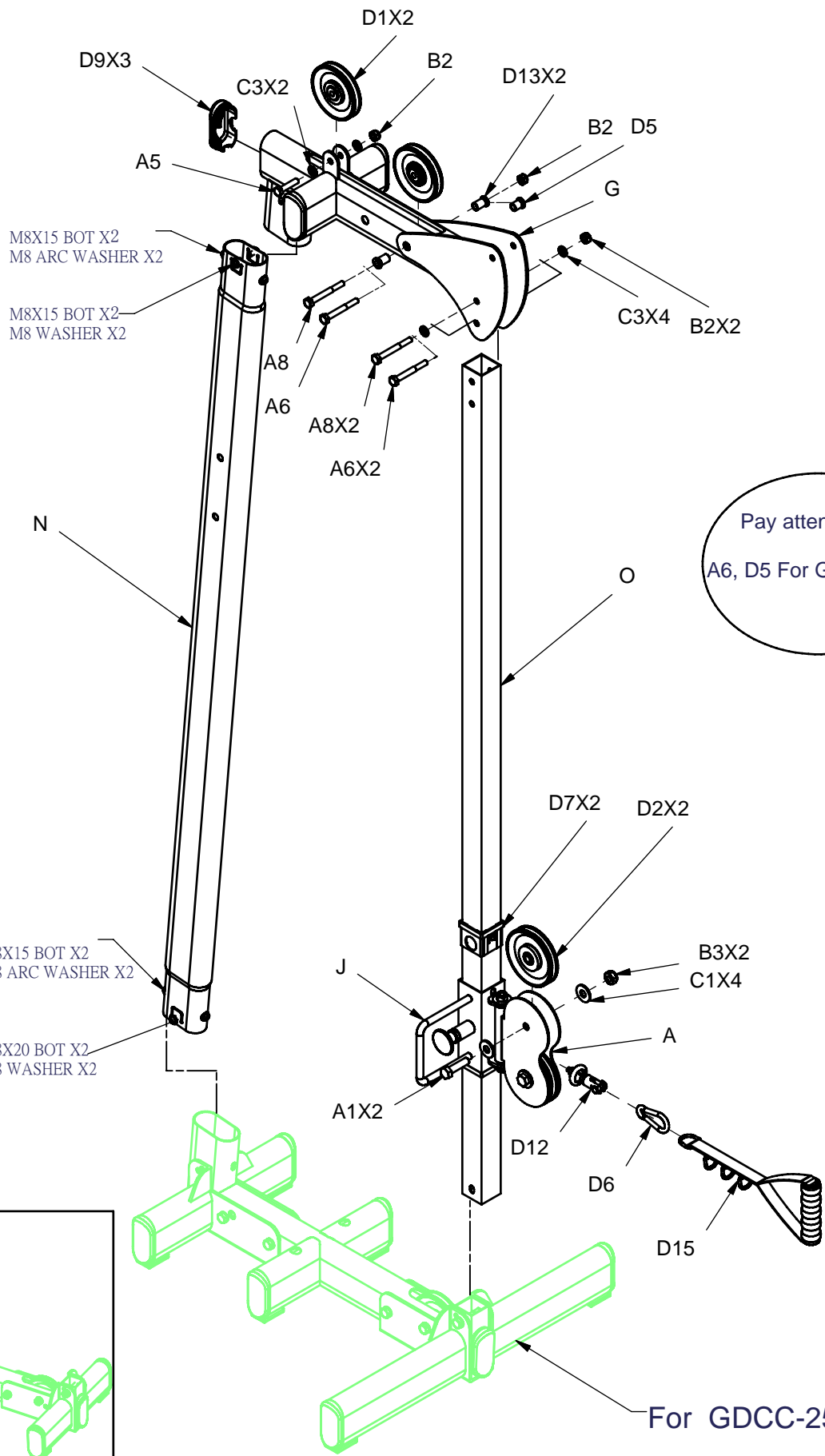

Pay attention to:
A6, D5 For GDCC200

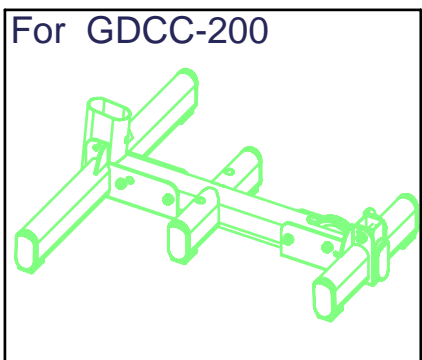

For GDCC-250

Allen Screw 5/16"x5/16" Full Threadx2

D8X2

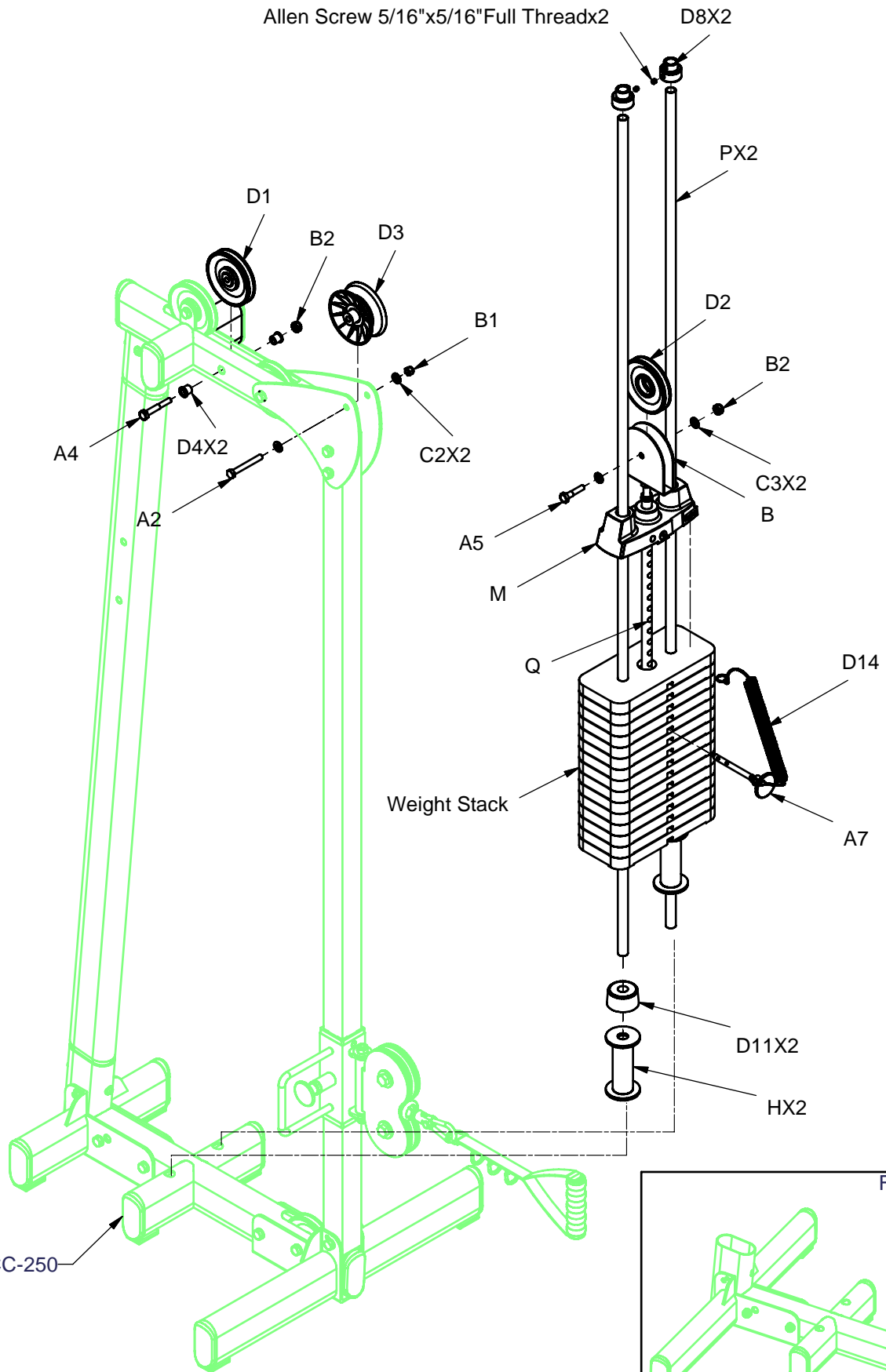

Weight Stack

For GDCC-250

For GDCC-200

GDCC-250

